

G ELECTRICAL WIRING ROUTING

□ : Location of Connector Joining Wire Harness and Wire Harness

▽ : Location of Ground Points

[1ZZ-FE]

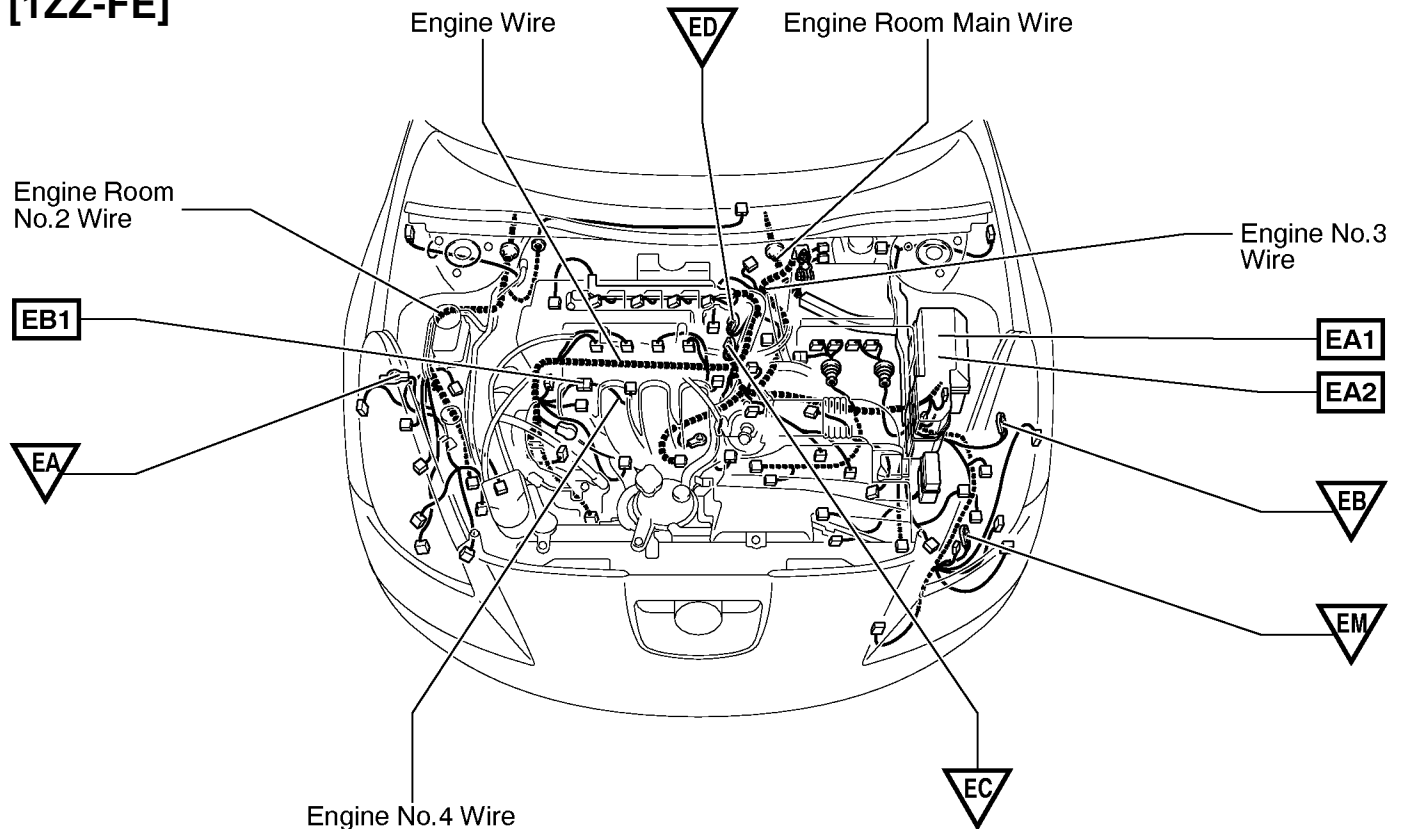

○ : Location of Splice Points

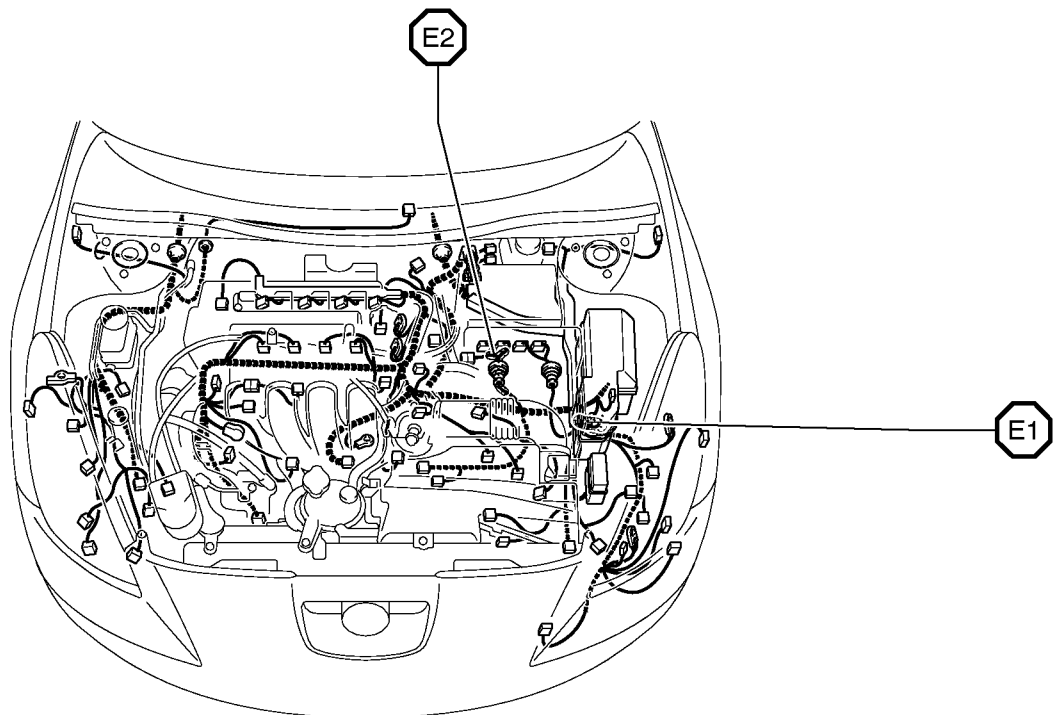

Connector Joining Wire Harness and Wire Harness

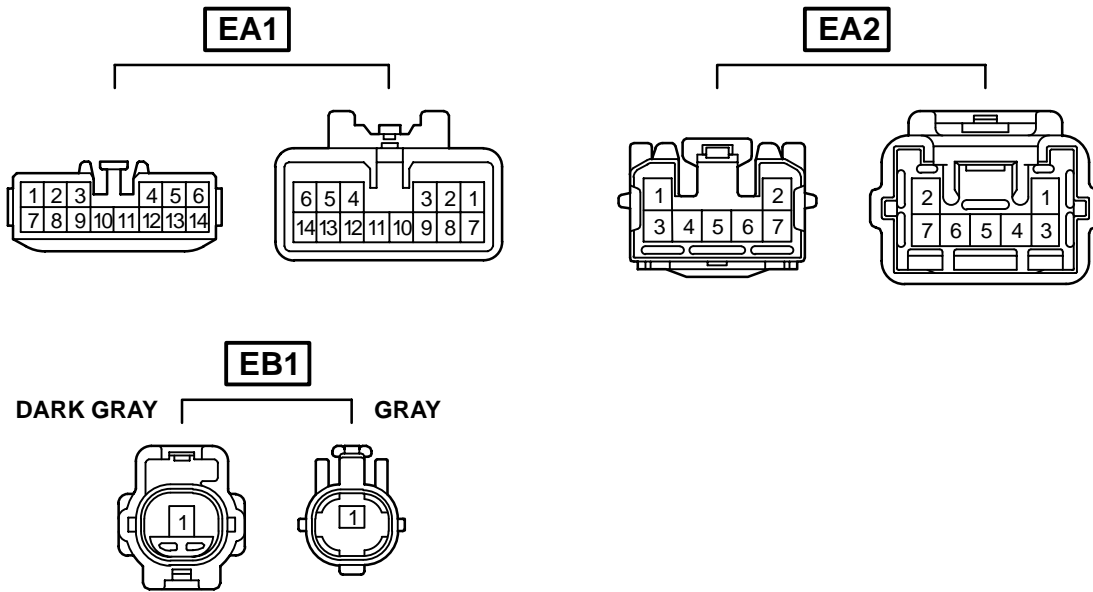

Code	Joining Wire Harness and Wire Harness (Connector Location)
EA1	Engine Wire and Engine Room Main Wire (Inside of Engine Room R/B No.1)
EA2	
EB1	Engine No.4 Wire and Engine Wire (Under the Intake Manifold)

G ELECTRICAL WIRING ROUTING

□ : Location of Connector Joining Wire Harness and Wire Harness

▽ : Location of Ground Points

[2ZZ-GE]

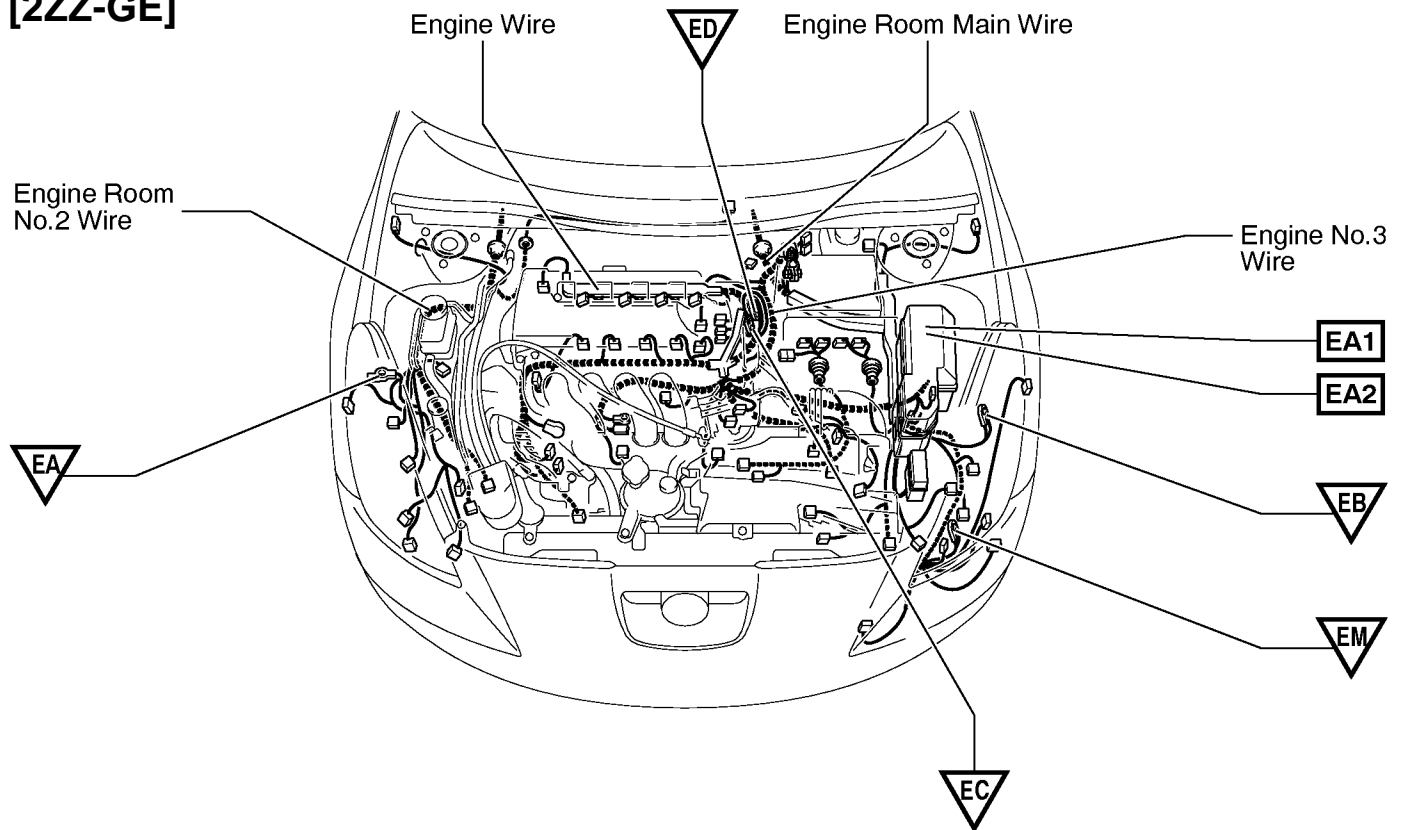

○ : Location of Splice Points

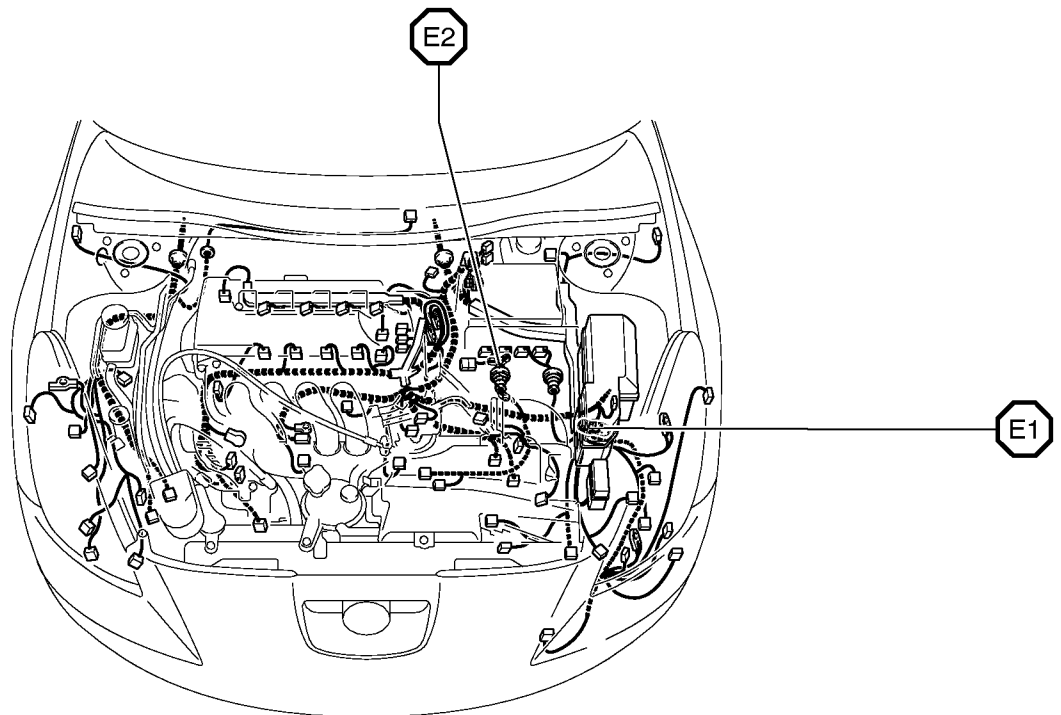

Connector Joining Wire Harness and Wire Harness

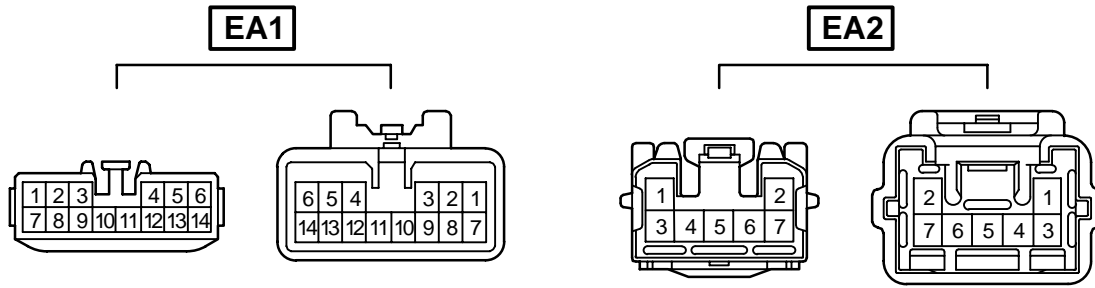

Code	Joining Wire Harness and Wire Harness (Connector Location)
EA1	Engine Wire and Engine Room Main Wire (Inside of Engine Room R/B No.1)
EA2	

G ELECTRICAL WIRING ROUTING

 : Location of Connector Joining Wire Harness and Wire Harness

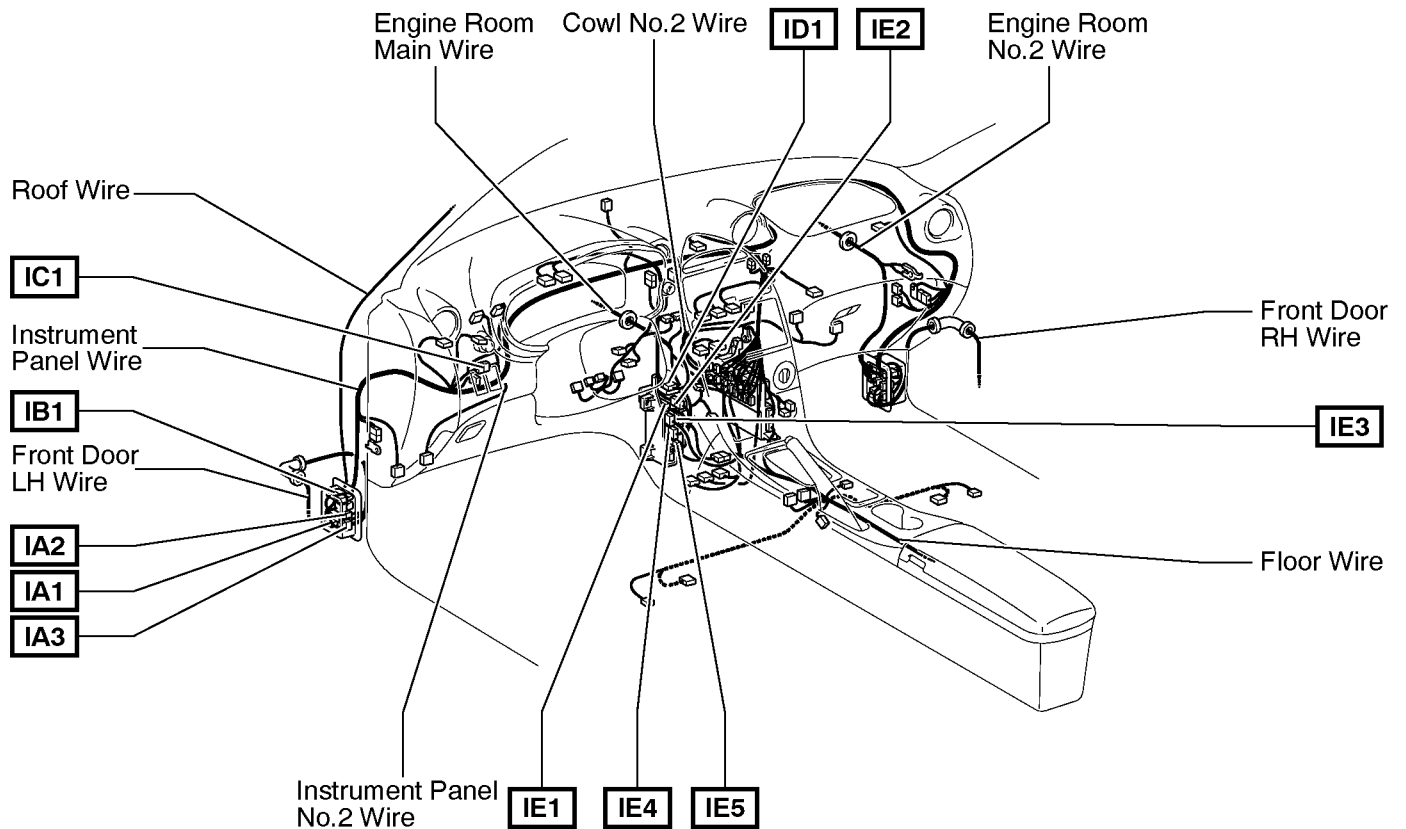

▽ : Location of Ground Points

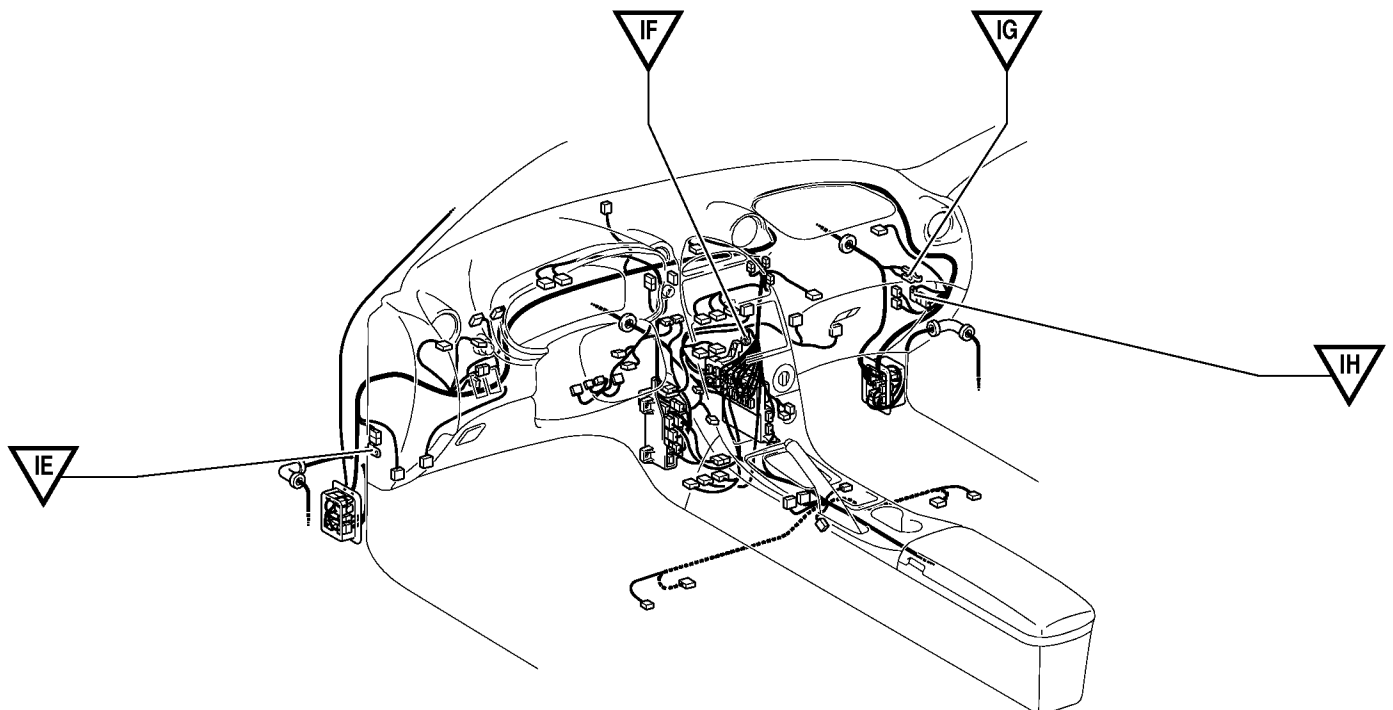

Connector Joining Wire Harness and Wire Harness

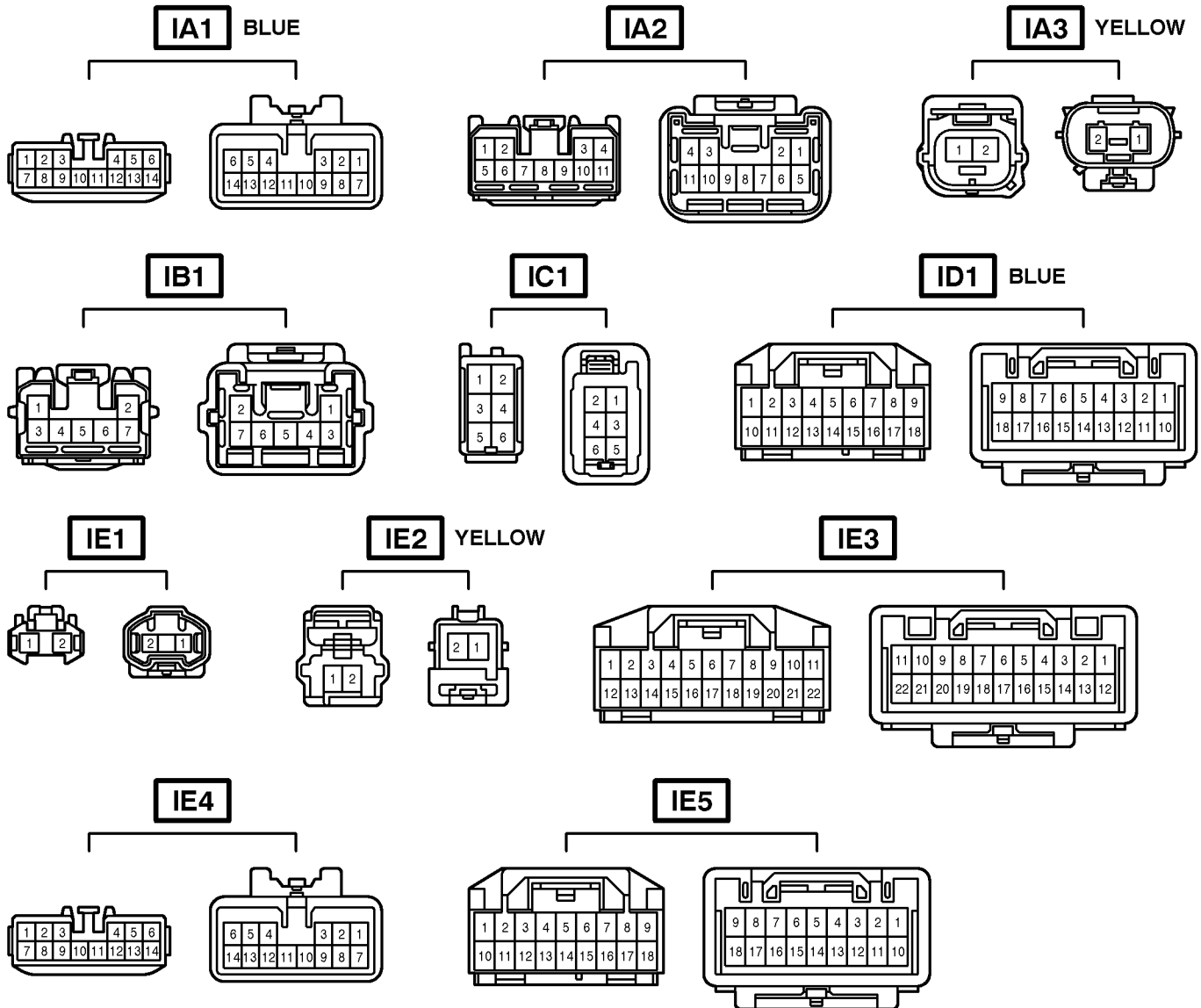

Code	Joining Wire Harness and Wire Harness (Connector Location)
IA1	Front Door LH Wire and Instrument Panel Wire (Left Kick Panel)
IA2	
IA3	
IB1	Roof Wire and Instrument Panel Wire (Left Kick Panel)
IC1	Instrument Panel Wire and Instrument Panel No.2 Wire (Instrument Panel Reinforcement LH)
ID1	Cowl No.2 Wire and Instrument Panel Wire (Instrument Panel Brace LH)
IE1	Engine Room Main Wire and Instrument Panel Wire (Instrument Panel Brace LH)
IE2	
IE3	
IE4	
IE5	

G ELECTRICAL WIRING ROUTING

□ : Location of Connector Joining Wire Harness and Wire Harness

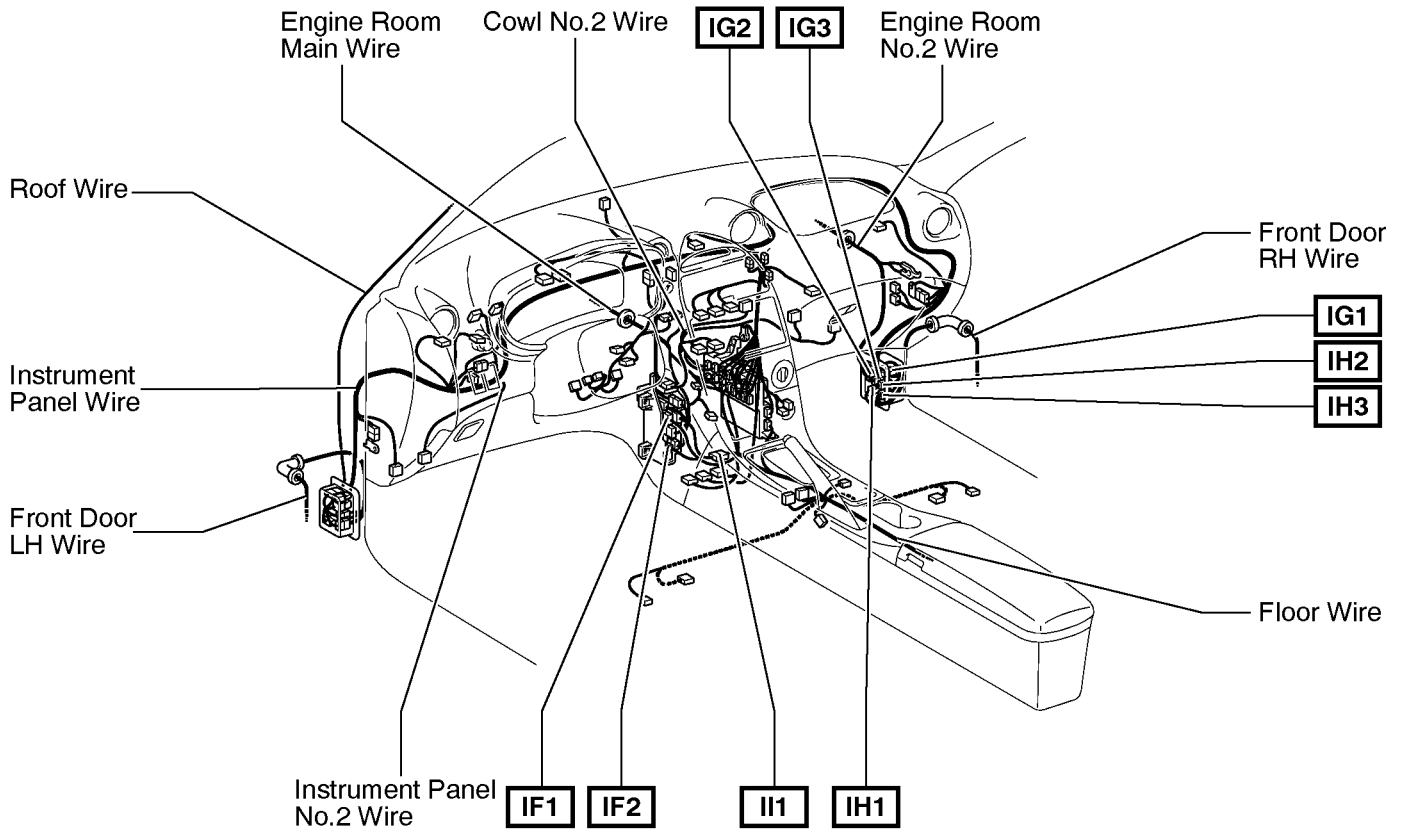

○ : Location of Splice Points

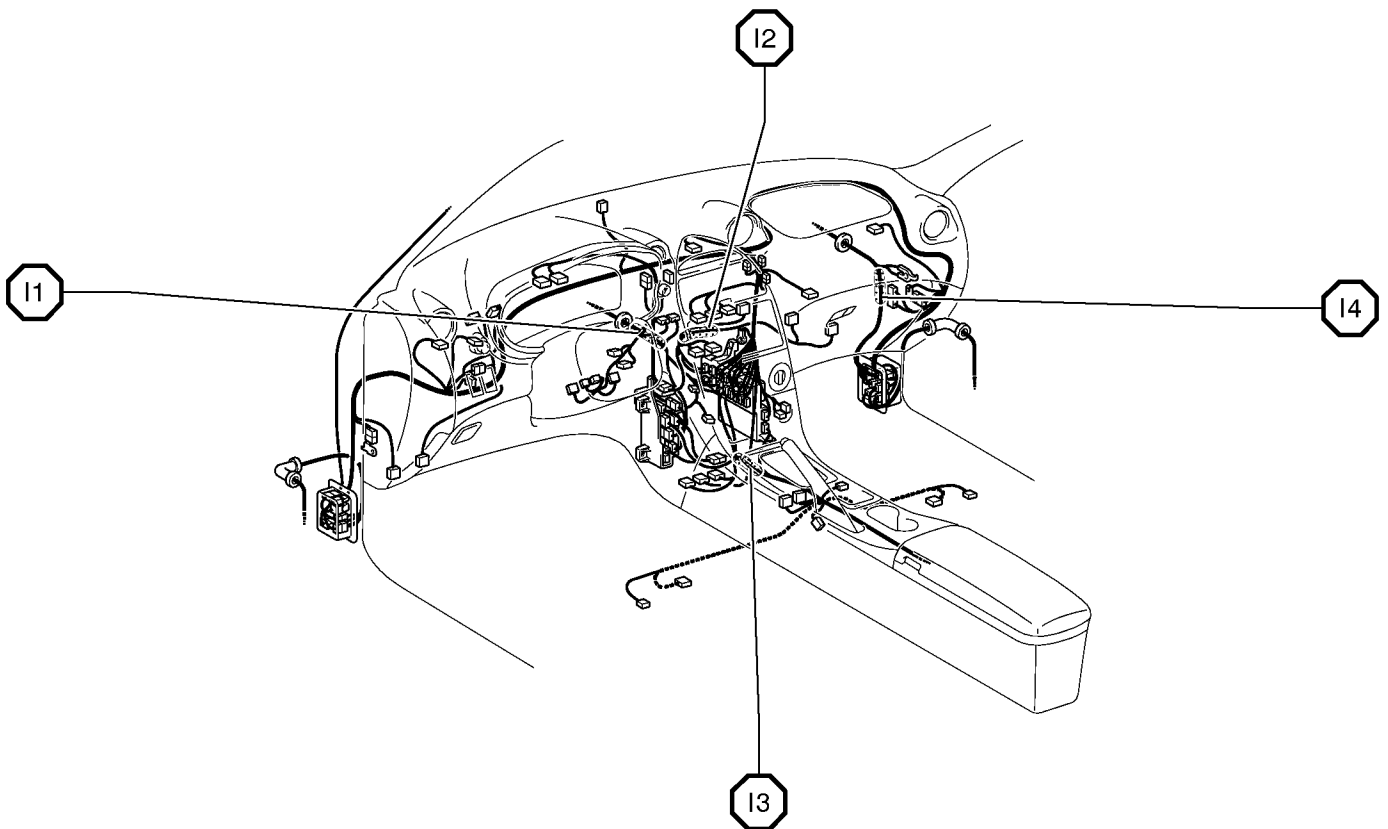

Connector Joining Wire Harness and Wire Harness

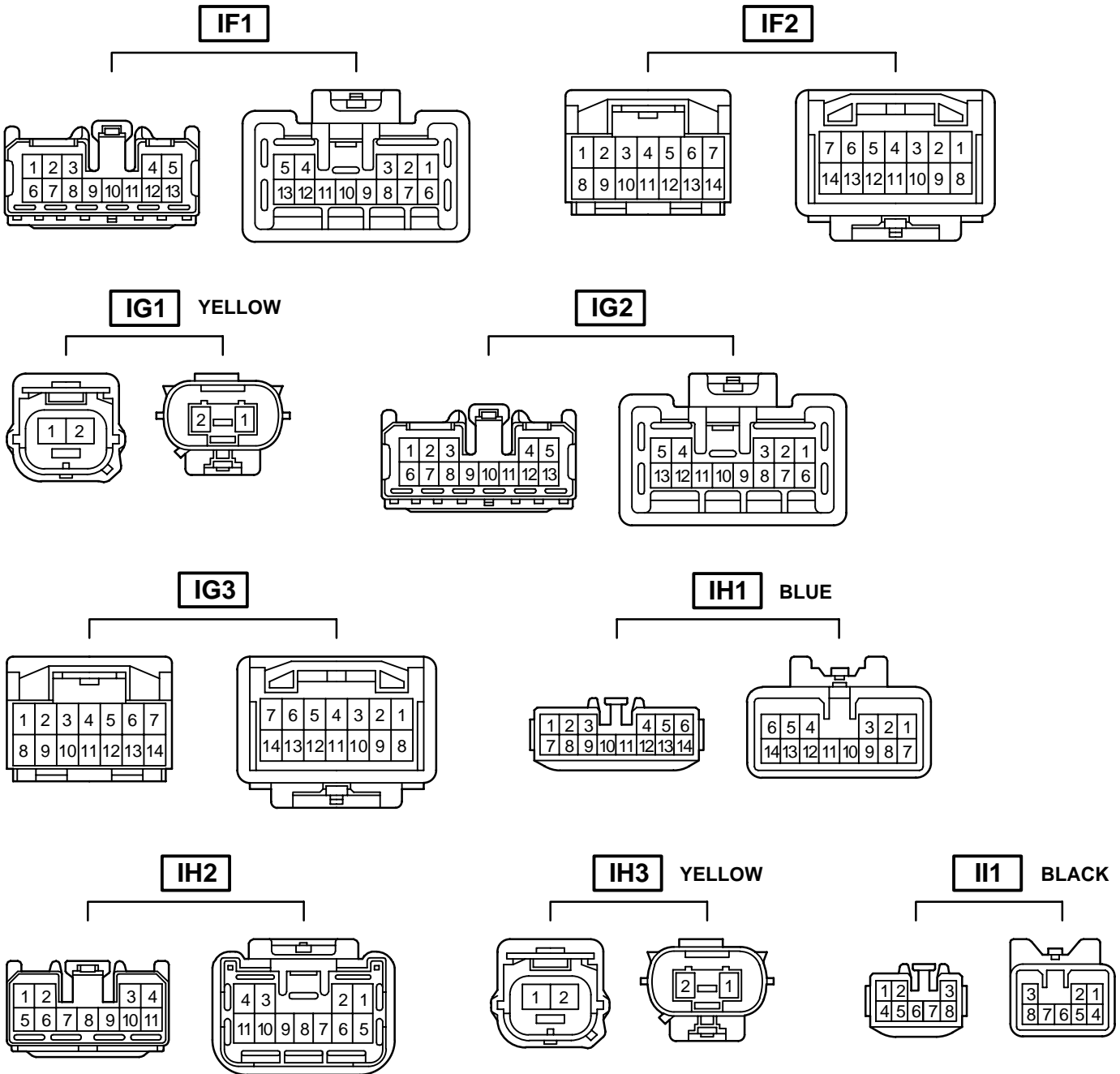

Code	Joining Wire Harness and Wire Harness (Connector Location)
IF1	Floor Wire and Instrument panel Wire (Instrument Panel Brace LH)
IF2	
IG1	Engine Room No.2 Wire and Instrument Panel Wire (Right Kick Panel)
IG2	
IG3	Front Door RH Wire and Instrument Panel Wire (Right Kick Panel)
IH1	
IH2	Engine Room Main Wire and Floor Wire (Instrument Panel Brace LH)
IH3	
II1	

G ELECTRICAL WIRING ROUTING

□ : Location of Connector Joining Wire Harness and Wire Harness

▽ : Location of Ground Points

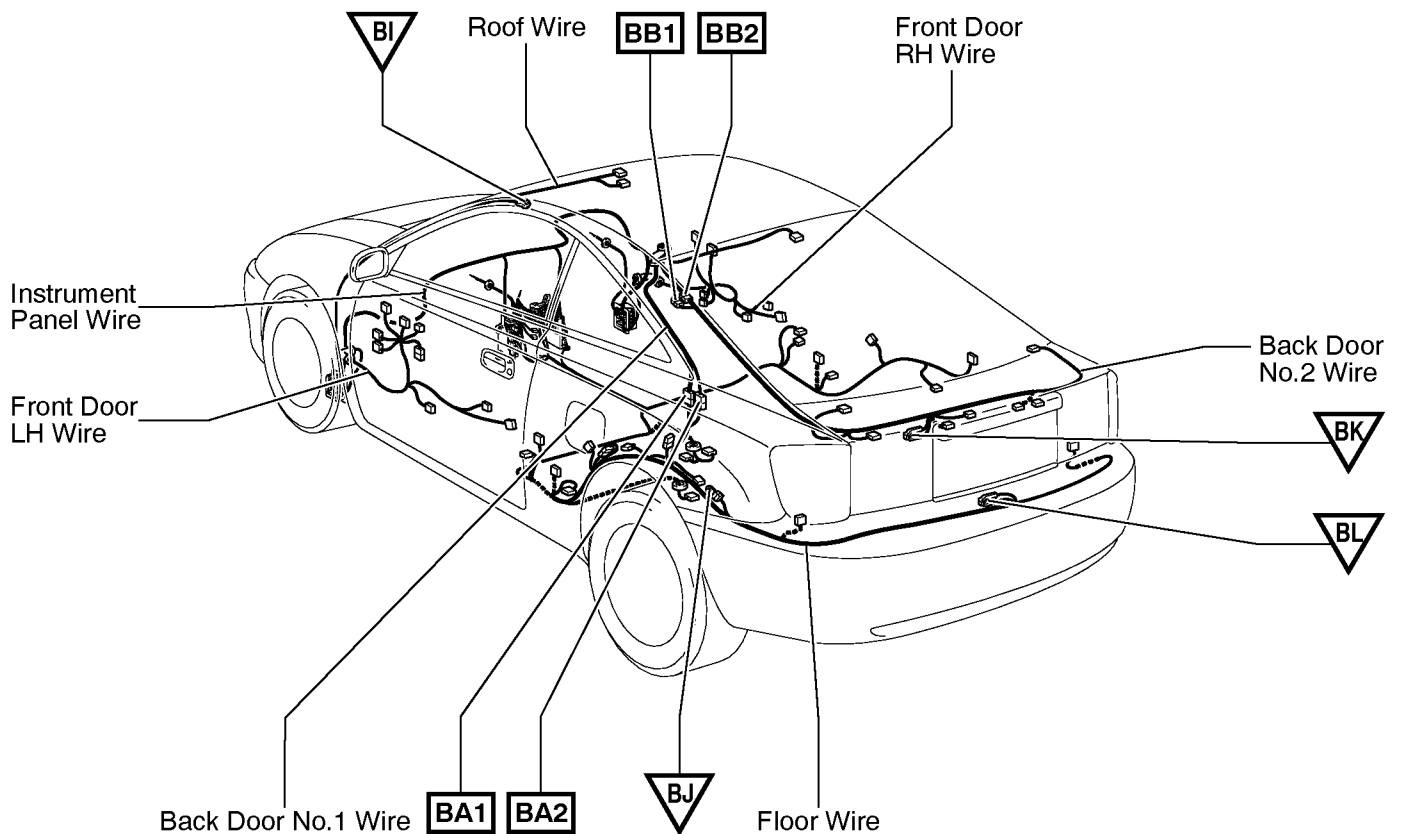

○ : Location of Splice Points

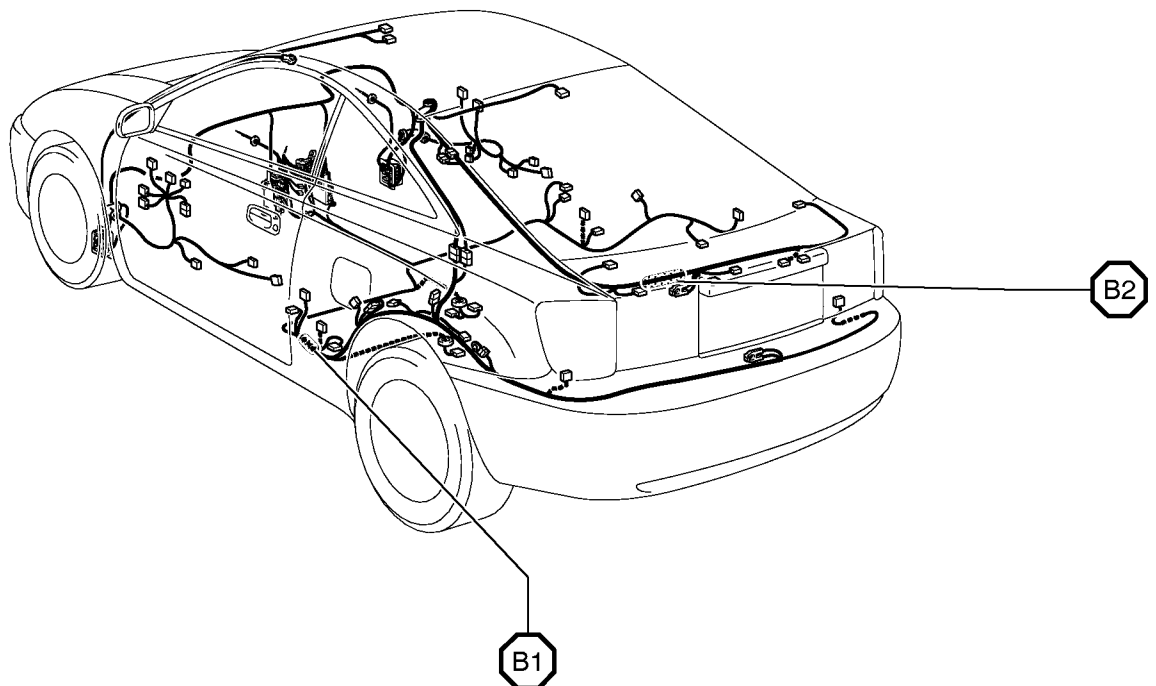

Connector Joining Wire Harness and Wire Harness

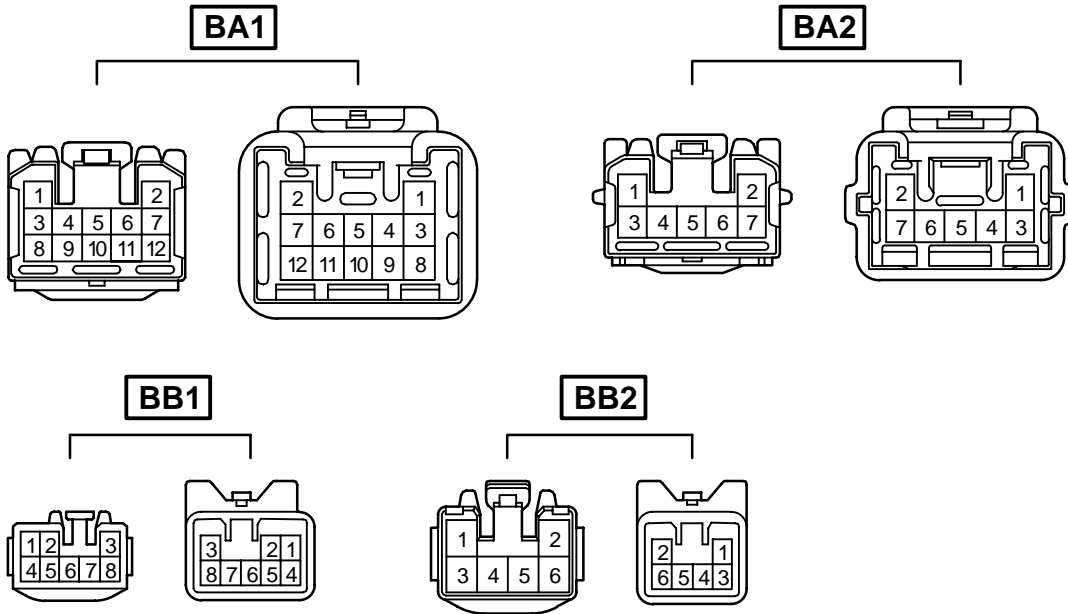

Code	Joining Wire Harness and Wire Harness (Connector Location)
BA1	Back Door No.1 Wire and Floor Wire (Quarter Panel LH)
BA2	
BB1	Back Door No.2 Wire and Back Door No.1 Wire (Back Door Upper Left)
BB2	